

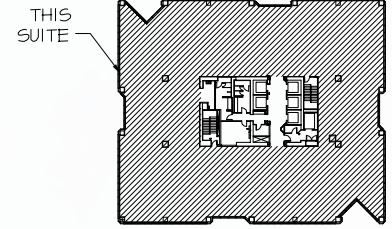

# RENAISSANCESQUARE

40 NORTH CENTRAL AVENUE | SUITE 2000 - 20,081 SF



KEY PLAN



**R. CRAIG COPPOLA**  
PRINCIPAL  
602.954.3762  
ccoppola@leearizona.com

**BILL BLAKE**  
PRINCIPAL  
602.954.3761  
bblake@leearizona.com

**ANDREW CHENEY**  
PRINCIPAL  
602.954.3769  
acheney@leearizona.com

**COLTON TRAUTER**  
PRINCIPAL  
602.474.9503  
ctrauter@leearizona.com

**GREGG KAFKA**  
PRINCIPAL  
602.954.3777  
gkafka@leearizona.com

**LEE & ASSOCIATES**  
COMMERCIAL REAL ESTATE SERVICES