

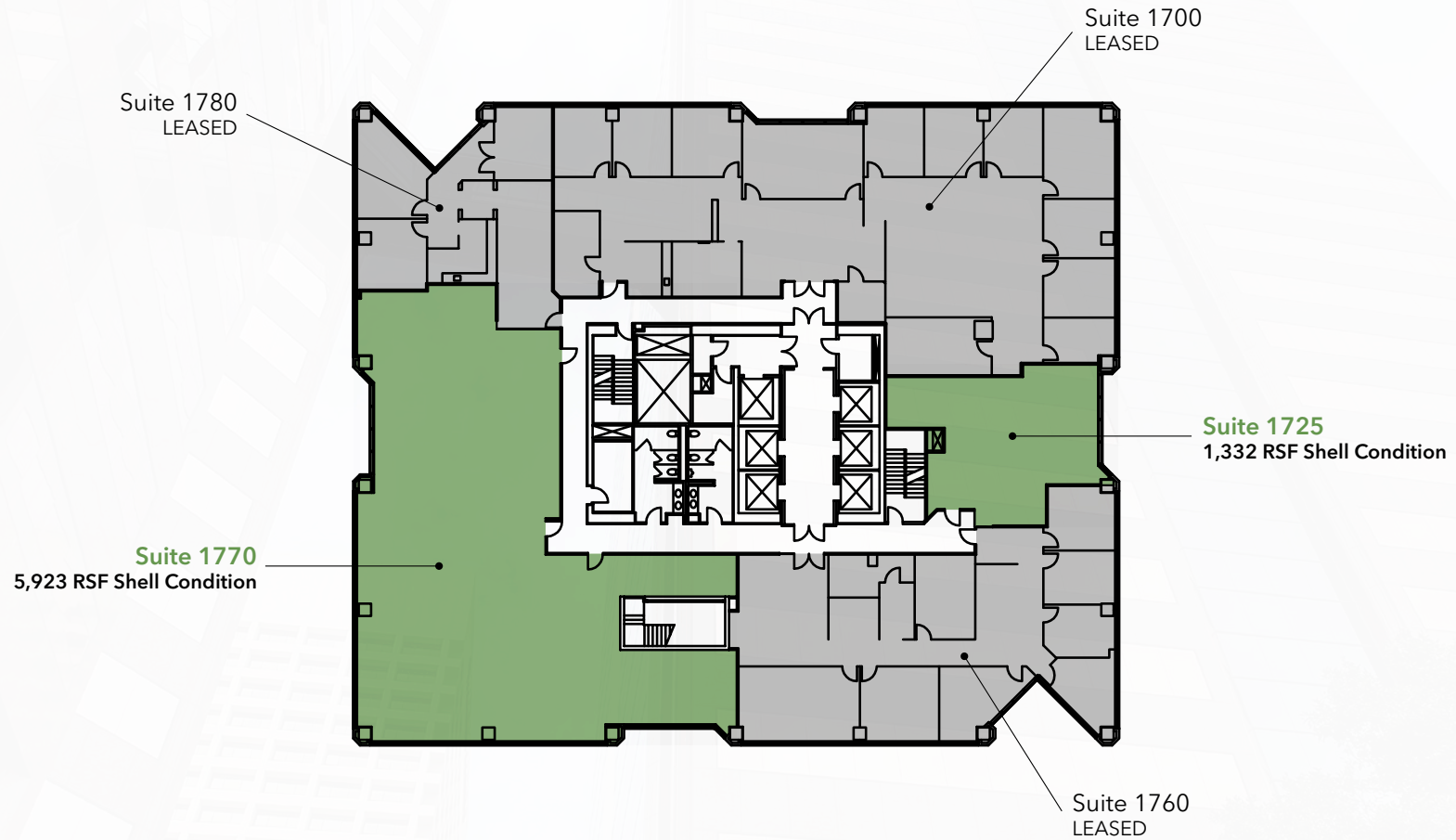

RENAISSANCESQUARE

2 NORTH CENTRAL AVENUE | SUITE 1725 -1,332 SF
SUITE 1770 -5,923 SF



R. CRAIG COPPOLA
PRINCIPAL
602.954.3762
ccoppola@leearizona.com

BILL BLAKE
PRINCIPAL
602.954.3761
bblake@leearizona.com

ANDREW CHENEY
PRINCIPAL
602.954.3769
acheney@leearizona.com

COLTON TRAUTER
PRINCIPAL
602.474.9503
ctrauter@leearizona.com

GREGG KAFKA
ASSOCIATE
602.954.3777
gkafka@leearizona.com

 **LEE & ASSOCIATES**
COMMERCIAL REAL ESTATE SERVICES