

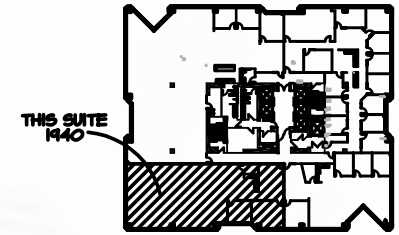

# RENAISSANCESQUARE

40 NORTH CENTRAL AVENUE | SUITE 1940 - 4,266 SF



SITE PLAN 

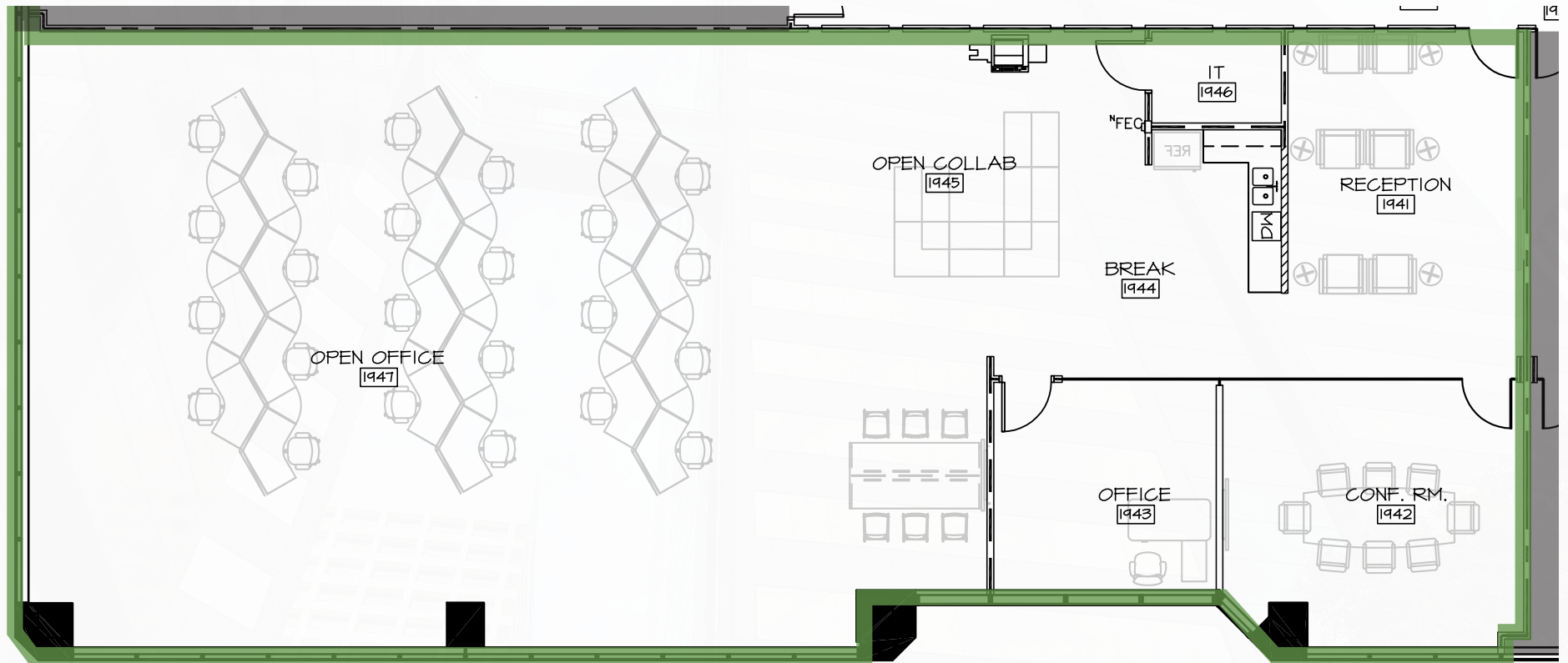

**R. CRAIG COPPOLA**  
PRINCIPAL  
602.954.3762  
ccoppola@leeearizona.com

**BILL BLAKE**  
PRINCIPAL  
602.954.3761  
bblake@leeearizona.com

**ANDREW CHENEY**  
PRINCIPAL  
602.954.3769  
acheney@leeearizona.com

**COLTON TRAUTER**  
PRINCIPAL  
602.474.9503  
ctrauter@leeearizona.com

**GREGG KAFKA**  
ASSOCIATE  
602.954.3777  
gkafka@leeearizona.com

 **LEE & ASSOCIATES**  
COMMERCIAL REAL ESTATE SERVICES